

GOVERNMENT OF MAHARASTRA

मा. बाळासाहेब ठाकरे कृषी व्यवसाय व ग्रामीण परिवर्तन
(स्मार्ट) प्रकल्प

पोंगेझरा फार्मर्स प्रोड्यूसर कंपनी

ESTIMATE

☉ Name Of Work ☉

PROPOSED CONSTRUCTION OF MACHINE SHED

☉ TOTAL ESTIMATED COST ☉

Rs. 2863308.00

ESTIMATE

Divison :-
Fund Head :-
Major Head :-
Minor Head :-
Service Head :-
Departmental Head :-

NAME OF WORK

PROPOSED CONSTRUCTION OF MACHINE SHED

Amount in Rs. 2863308.00

Administratively Approved Under :-
No. Dated :-
Technically Sanctioned Under :-
No. Dated :-
Estimate Prepared by :- Er. K.D. Pardhi
Estimate Checked by :-
Call of Authority :-

GENERAL DESCRIPTION

ATTACHED SEPARATELY

Er. K. D. Pardhi
BE (Civil), DCE

GENERAL REPORT AND SPECIFICATION

- 1 Name of Work :- PROPOSED CONSTRUCTION OF MACHINE SHED
- 2 Location :-
- 3 Estimated Cost in Rs. :- Rs. 2863308.00
- 4 Head :-
- 5 Authority :-
- 6 Provison :- The Following Provison one made in the Estimate
- 1 Excavation for foundation
 - 2 Filling in plinth and floors with contractors material/brought from outside
 - 3 Providing and laying Cast in situ/Ready Mix cement concrete in M-10
 - 4 Providing and laying in situ /Ready Mix cement concrete M-20 for R.C.C. work in foundations, column, Beam, Lintel, slab and chajja
 - 5 Providing and fixing in position TMT - FE - 500 bar
 - 6 Providing fly ash brick masonry with conventional / I.S. type fly ash bricks in C.M. 1:6 in foundation, plinth and
 - 7 Providing internal cement plaster 6 mm thick, 12mm thick and sand faced plaster to external wall surface
 - 8 Providing and laying cement concrete flooring 50mm
 - 9 Providing and applying priming coat and plastic emulsion paint to internal wall surface
 - 10 Providing and applying priming coat water proof cement paint to external wall surface
- 7 Rates/ Specifications :- Rates adopted as per S.S.R. for 2021-2022 is applicable for Public Work Region, Nagpur with effect from 06/08/ 2021 & work will be executed as per standard specification and P.W.D. hand book Vol-I and as per directed by Engineer-in-Charge

Dr. K. D. Pardhi
BE (Civil), DCB

GENERAL ABSTRACT

PROPOSED CONSTRUCTION OF MACHINE SHED

Sr.No.	Description	Amount
1	Cost Of Civil Work	Rs. 2488588.00
2	Add for Testing Charges	Rs. 5520.00
3	Add for Royalty Charges	Rs. 39793.00
	Total Amount	Rs. 2533901.00
4	Add For GST @ 12%	Rs. 304068.00
5	Add For Labour Insurance @ 1%	Rs. 25339.00
	Grand Total Amount	Rs. 2863308.00
	Say Amount	Rs. 2863308.00

Er. K. D. Pardhi
BE (Civil), DCE

PROPOSED CONSTRUCTION OF MACHINE SHED

ABSTRACT

Sr.No.	Particulars of Item	Quantity	Rate	Per	Amount
1	Excavation for foundation in earth, soil of all types, sand, gravel and soft murum, including removing the excavated material up to a distance of 50 m. beyond the building area and stacking and spreading as directed, dewatering, preparing the bed for the foundation and necessary back filling, ramming, watering including shoring and strutting etc. complete. (Lift upto 1.5 m.) By Mechanical Means	40.50	193.00	Cu.m	7817.00
2	Excavation for foundation in earth, soils of all types, sand, gravel and soft murum, including removing the excavated material upto a distance of 50 metres beyond the building area and stacking and spreading as directed, dewatering, preparing the bed for the foundation and necessary back filling, ramming, watering including shoring and strutting etc. complete. (Lift from 1.5m to 3.0m) By Mechanical Means	16.20	306.00	Cu.m	4957.00
3	Providing soling using 80mm size trap metal in 15cm. Layer including filling voids with Crushed sand/ grit, ramming, watering etc. complete.	34.48	1778.00	Cu.m	61314.00
4	Filling in plinth and floors with contractors material/brought from outside and approved by Engineer incharge in layers of 15 cm to 20 cm including watering and compaction etc. complete.	59.49	770.00	Cu.m	45804.00
5	Providing and laying Cast in situ/Ready Mix cement	24.39	6221.00	Cu.m	151754.00
6	Providing and laying in situ /Ready Mix cement concrete M-20 of trap / granite /quartzite/ gneiss metal for R.C.C. work in foundations like raft, strip foundations, grillage and footings of R.C.C. columns and steel stanchions etc. including bailing out water, Steel centering formwork, laying/pumping cover blocks, compaction and curing roughening the surface if special finish is to be provided (Excluding reinforcement and structural steel) etc. complete, with fully automatic micro processor based PLC with SCADA enabled reversible Drum Type mixer/ concrete Batch mix plant (Pan mixer) etc. complete. With fine aggregate (Crushed sand VSI Grade)	6.91	7302.00	Cu.m	50471.00

Er. K. D. Pardhi
BE (Civil), DCE

7	Providing and laying Cast in situ/Ready Mix cement concrete M-20 of trap / granite/quartzite/ gneiss metal for R.C.C. columns as per detailed designs and drawing or as directed including steel centering, formwork, cover blocks, laying/pumping, compaction finishing the formed surfaces with cement mortar 1:3 of sufficient minimum thickness to give a smooth and even surface or roughening if special finish is to be provided and curing etc. complete.(Excluding reinforcement and structural steel).with fully automatic micro processor based PLC with SCADA enabled reversible Drum Type mixer/ concrete Batch mix plant (Pan mixer) etc. complete. With fine aggregate (Crushed sand VSI Grade)	11.42	13623.00	Cu.m	155588.00
8	Providing and laying Cast in situ/Ready Mix cement concrete M-20 of trap / granite/quartzite/ gneiss metal for R.C.C. beams and lintels as per detailed designs and drawings or as directed including steel centering, formwork, cover blocks, laying/pumping, compaction and roughening the surface if special finish is to be provided and curing etc. complete. (Excluding reinforcement and structural steel), with fully automatic micro processor based PLC with SCADA enabled reversible Drum Type mixer/ concrete Batch mix plant (Pan mixer) etc. complete. With fine aggregate (Crushed sand VSI Grade)	9.45	12119.00	Cu.m	114541.00
9	Providing and laying Cast in situ/Ready Mix cement concrete M-20 of trap/ granite /quartzite/ gneiss metal for R.C.C. slabs and landings as per detailed designs and drawings including steel centering, formwork, cover blocks, laying/pumping, compaction finishing the formed surfaces with cement mortar 1:3 of sufficient minimum thickness to give a smooth and even surface or roughening if special finish is to be provided and curing etc. complete.(Excluding reinforcement and structural steel).with fully automatic micro processor based PLC with SCADA enabled reversible Drum Type mixer/ concrete Batch mix plant (Pan mixer) etc. complete. With fine aggregate (Crushed sand VSI Grade)	0.00	14579.00	Cu.m	0.00
10	Providing and laying Cast in situ/Ready Mix cement concrete M-20 of trap/ granite/ quartzite/gneiss metal for R.C.C. chajja as per detailed design and drawings including steel centering, formwork, cover blocks, laying/pumping, compacting and roughening the surface if special finish is to be provided and curing complete. (Excluding reinforcement and structural steel). with fully automatic micro processor based PLC with SCADA enabled reversible Drum Type mixer/ concrete Batch mix plant (Pan mixer) etc. complete. With fine aggregate (Crushed sand VSI Grade)	0.84	13747.00	Cu.m	11547.00

Er. K. D. Parthi
BE (Civil), DCE

11	Providing and fixing in position TMT - FE - 500 bar reinforcement of various diameters for R.C.C. pile caps, footings, foundations, slabs, beams columns, canopies, staircase, newels, chajjas, lintels pardis, copings, fins, arches etc. as per detailed designs, drawings and schedules. including cutting, bending, hooking the bars, binding with wires or tack welding and supporting as required complete.	2.84	71965.00	M.T.	204680.00
12	Providing fly ash brick masonry with conventional / I.S. type fly ash bricks in C.M. 1:6 in foundation and plinth including bailing out water manually striking joints, racking out joints watering and scaffolding etc. complete.	4.48	7287.00	Cu.m	32632.00
13	Providing fly ash brick masonry with conventional/ I.S. type bricks in cement mortar 1:6 in superstructure including striking joints, raking out joints, watering and scaffolding etc. Complete	54.63	7503.00	Cu.m	409851.00
14	Providing internal cement plaster 20mm thick in Single coats in cement mortar 1:4 without neeru finish, to concrete, brick surface, in all positions including scaffolding and curing etc. complete.	232.85	378.00	Sq.m	88017.00
15	Providing sand faced plaster externally in cement mortar using approved screened sand, in all positions including base coat of 15 mm thick in cement mortar 1:4 using waterproofing compound at 1Kilogramper cement bag curing the same for not less than 2 days and keeping the surface of the base coat rough to receive the sand faced treatment 6 to 8 mm thick in cement mortar 1:4 finishing the surface by taking out grains and curing for fourteen days scaffolding etc. complete	282.68	624.00	Sq.m	176392.00
16	Providing and laying cement concrete flooring 50mm thick with M20 cement concrete laid to proper level and slope in alternate bays including compacting, filling joints, marking lines to give the appearance of tiles of 30cmx30cm or other size laid diagonally / square etc. finishing smooth (with extra cement) in any colour as directed and curing etc. complete. with Crushed sand VSI Grade	165.65	587.00	Sq.m	97235.00
17	Providing and fixing mild steel grill work for windows, ventilators etc. 20 Kilogram/Square Metre as per drawing including fixtures, necessary welding and painting with one coats of anticorrosive paint and two coats of oil painting complete.	15.12	1845.00	Sq.m	27896.00

Er. K. D. Pardhi
BE (Civil), DCE

18	Providing and fixing in position. (as per I.S.1868 / 1982) Aluminium sliding window of two tracks with rectangular pipe having overall dimension 763.50 x 38.10 x 1.02 mm at weight 0.547 kg/Rmt. and window frame bottom track section 61.85 x 31.75 x 1.20 mm at weight 0.695 kg/Rmt. Top and side track section 61.85 x 31.75 x 1.30 mm at weight 0.659 kg/Rmt. The shutter should be of bearing bottom 40 x 18 x 1.25 mm at weight 0.417 kg/Rmt. Inter locking section 40 x 18 x 1.10 mm at weight 0.469 kg/Rmt. And handle section 40 x 18 x 1.25 mm at weight 0.417 kg/Rmt. and top section 40 x 18 x 1.25 mm at weight 0.417 kg/Rmt. As per detailed drawings and as directed by Engineer in charge with all necessary Aluminium sections fixtures and fastenings such as roller bearing in nylon casting and self locking catch fitted in vertical section of shutter including 5 mm thick plain glass with all required screws and nuts etc, complete. With powder coating without box	15.12	4769.00	Sq.m	72107.00
19	Solid Core Flush door Single leaf Providing and fixing factory made solid core flush door in single leaf 35 mm thick, decorative types, of exterior grade, as per detailed drawings, conforming to I.S.:2202 - 1962 (Revised) with approved face veneers on both faces with/without glazing and venetians in the positions shown on the drawings or as directed, all necessary beads, moulding and lipping, holdfasts, mat finish stainless steel fixtures fastenings, finishing with french-polish/ waxing complete. (without door frame).(Sample to be got approved from Ex.Engineer before use) Commercial Hard Wood shutter	0.00	2750.00	Sq.m	0.00
20	Providing and fixing rolling shutter fabricated from steel laths of minimum thickness 0.9 mm with lock plate of 3.15 mm thickness reinforced with 35 x 35 x 5 mm angle section fitted with sliding bolts and handles for both sides, deep M.S. channel section of depth and thickness not less than 65 mm and 3.15 mm respectively with hold fast arrangements, M.S. Bracket plate 300 x 300 x 3.15 mm minimum size and shape with square bar, suspension shaft of minimum 32 mm diameter, hood cover of M.S. sheet not less than 0.9 mm thickness and of any size at top and safety devices including mechanical gear operation arrangement consisting of worm gear wheels and worms of high grade cast iron or mild steel and one coat of red lead primer etc. complete. (I.S. 62481979) (With mechanical gear)	11.88	4730.00	Sq.m	56192.00
21	Providing and applying priming coat on concrete/ masonry/ Asbestos Cement plastered surfaces including scaffolding if necessary, preparing the surface by thoroughly cleaning oil, grease, dirt and other foreign matter and sand papering as required etc. complete	232.85	34.00	Sq.m	7917.00

Er. K. D. Pardhi
BE (Civil), DCE

22	Providing and applying plastic emulsion paint of approved quality, colour and shade to old and new surfaces in two coats including scaffolding, preparing the surface. (excluding the primer coat)etc. complete.	232.90	70.00	Sq.m	16303.00
23	Providing and applying one coat of seal cement primer of approved manufacture and shed including scaffolding preparing the surface by cleaning dirt and other foreign matters, scrapping if necessary including scaffolding etc. complete.	282.68	19.00	Sq.m	5371.00
24	Providing and applying two coats of exterior acraylic emulsion paint confirming to corresponding I.S. of approved manufacture and of approved colour to the plastered surfaces including cleaning ,preparing the plaster surface, applying primer coat ,scaffolding if necessary , and watering the surface for two days etc complete.	279.38	240.00	Sq.m	67051.00
25	Providing and fixing colour coated Zinalume (R) AZ150 (min 150 gms/sq.mt. total on each side) profiled sheets for roofing. The feed material is manufactured out of nominal 0.45 mm Base Metal Thickness (BMT) (0.5 mm TCT), Hi-strength steel with min.550 MPa yield strength, metallic hot dip coated with Aluminium-Zinc alloy (55% aluminium 43.4% zinc 1.6% silicon) with COLORBOND (R) steel quality super durable polyester paint coat (with inorganic pigment). The paint shall have a total coating thickness of nominal 35 um, comprising of nominal 25 um exterior coat on top surface and nominal 10 um reverse coat on back surface. Profile sheet shall have nom. 950-1050 mm effective cover width and nominal 25-30 mm deep ribs with subtle square fluting in the five pan at nominal 180-250 mm center-to-center. The end rib shall be designed for anti-capillary groove. and return leg. The feed material should have coil manufacturers product details marked a regular interval. Including fasteners with min. fastened with min. 25 um Zinc-Tin alloy coated, Hex head, self-drilling screw etc. complete. (weight of profile 4.52 kg/sqm)	198.78	1095.00	Sq.m	217664.00
26	Providing structural steel work in hollow section of various thickness and sizes in square, rectanular and round shape from 25mm to 450mm section as per IS 4923 YST 310 Grade produced from iron ore and blast furnace route etc. as per detailed designs and drawing or as directed including cutting, fabricating, hoisting, erecting, fixing in position, making riveted/bolted/ welded connections and painting complete.	3.98	101994.00	M.T.	405487.00
				Total Amount Rs.	2488588.00

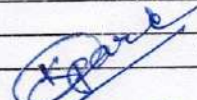
Er. K. D. Pardhi
BE (Civil), DCE

PROPOSED CONSTRUCTION OF MACHINE SHED

MEASUREMENTS

It. No.	Item of work	No	L	B	D/H	Qty
1	Excavation for foundation in earth, soil of all types, sand, gravel and soft murum, including removing the excavated material up to a distance of 50 m. beyond the building area and stacking and spreading					
	Foundation Pit	12	1.50	1.50	1.50	40.50
						Total Qty = 40.50 Cu.m
2	Excavation for foundation in earth, soils of all types, sand, gravel and soft murum, including removing the excavated material upto a distance of 50 metres beyond the building area and stacking and					
	Foundation Pit	12	1.50	1.50	0.60	16.20
						Total Qty = 16.20 Cu.m
3	Providing soling using 80mm size trap metal in 15cm. Layer including filling voids with Crushed sand/ grit, ramming, watering etc. complete.					
	Below Footing	12	1.50	1.50	0.15	4.05
	for Floor	1	10.95	16.40	0.15	26.92
	below Ramp	1	3.90	6.00	0.15	3.51
						Total Qty = 34.48 Cu.m
4	Filling in plinth and floors with contractors material/brought from outside and approved by Engineer incharge in layers of 15 cm to 20 cm including watering and compaction etc. complete.					
	Below Floor	1	9.75	16.24	0.35	55.39
	below Ramp	1	3.90	6.00	0.18	4.10
						Total Qty = 59.49 Cu.m
5	Providing and laying Cast in situ/Ready Mix cement concrete in M-10 of trap/ granite/quartzite/ gneiss metal for foundation and bedding including bailing out water, Steel centering, formwork,					
	Below Foundation	12	1.50	1.50	0.15	4.05
	Below Plinth beam	8	3.80	0.45	0.10	1.37
		4	4.50	0.45	0.10	0.81
	For Floor	1	9.75	16.24	0.10	15.83
	Ramp	1	3.90	6.00	0.10	2.34
						Total Qty = 24.39 Cu.m
6	Providing and laying in situ /Ready Mix cement concrete M-20 of trap / granite /quartzite/ gneiss metal for R.C.C. work in foundations like raft, strip foundations, grillage and footings of R.C.C. columns					
	Footing	12	1.20	1.20	0.40	6.91
						Total Qty = 6.91 Cu.m
7	Providing and laying Cast in situ/Ready Mix cement concrete M-20 of trap / granite/quartzite/ gneiss metal for R.C.C. columns as per detailed designs and drawing or as directed including steel centering,					

Er. K. D. Pardhi
BE (Civil), DCE

Upto plinth	12	0.45	0.30	2.05	3.32
Above plinth	12	0.45	0.30	5.00	8.10

Total Qty = **11.42** Cu.m

8 Providing and laying Cast in situ/Ready Mix **cement concrete M-20** of trap / granite/quartzite/ gneiss metal for **R.C.C. beams and lintels** as per detailed designs and drawings or as directed including steel

Plinth beam	8	3.80	0.23	0.40	2.80
	4	4.50	0.23	0.40	1.66
Lintel beam	7	2.26	0.23	0.15	0.55
Top Beam	8	3.80	0.23	0.40	2.80
	4	4.50	0.23	0.40	1.66

Total Qty = **9.45** Cu.m

9 Providing and laying Cast in situ/Ready Mix **cement concrete M-20** of trap/ granite /quartzite/ gneiss metal for **R.C.C. slabs and landings** as per detailed designs and drawings including steel centering,

	0	4.66	5.79	0.10	0.00
--	---	------	------	------	------

Total Qty = **0.00** Cu.m

10 Providing and laying Cast in situ/Ready Mix **cement concrete M-20** of trap/ granite/ quartzite/gneiss metal for **R.C.C. chajja** as per detailed design and drawings including steel centering, formwork, cover

For window	7	2.00	0.60	0.10	0.84
------------	---	------	------	------	------

Total Qty = **0.84** Cu.m

11 Providing and fixing in position **TMT - FE - 500 bar reinforcement** of various diameters for R.C.C. pile caps, footings, foundations, slabs, beams columns, canopies, staircase, newels, chajjas, lintels pardis,

For footing @ 40 kg/cu.m	1				276.48
For column @ 120 kg/cu.m	1				1370.52
For Beam @ 120 kg/cu.m	1				1134.17
For Slab @ 75 kg/cu.m	1				0.00
For chhajja @ 75 kg/cu.m	1				63.00

Total Qty = **2.84** M.T.

12 Providing **fly ash brick masonry** with conventional / I.S. type fly ash bricks in C.M. 1:6 in **foundation and plinth** including bailing out water manually striking joints, racking out joints watering and

upto Plinth	8	3.80	0.23	0.30	2.10
	5	4.50	0.23	0.30	1.55
For Ramp side walls	2	6.00	0.23	0.30	0.83

Total Qty = **4.48** Cu.m

13 Providing **fly ash brick masonry** with conventional/ I.S. type bricks in cement mortar 1:6 in **superstructure** including striking joints, raking out joints, watering and scaffolding etc.Complete

Above Plinth	8	3.80	0.23	5.00	34.96
	5	4.50	0.23	5.00	25.88
deduction for window	-7	1.80	0.23	1.20	-3.48

Er. K. D. Pardhi
BE (Civil), DCE

Roling Shutter -1 3.30 0.23 3.60 -2.73

Total Qty = 54.63 Cu.m

14 Providing **internal cement plaster 20mm thick** in Single coats in cement mortar 1:4 without neeru finish, to concrete, brick surface, in all positions including scaffolding and curing etc.complete.

Internal	2	9.75	-	5.00	97.45
	2	16.24	-	5.00	162.40
Deduction for RS	-1	3.30	-	3.60	-11.88
Window	-7	1.80	-	1.20	-15.12

Total Qty = 232.85 Sq.m

15 Providing **sand faced plaster** externally in cement mortar using approved screened sand, in all positions including base coat of 15 mm thick in cement mortar 1:4 using waterproofing compound at

External	2	10.20	-	5.60	114.24
	2	16.70	-	5.60	187.04
Chhaja	7	2.00	0.60	-	8.40
deduction for RS	-1	3.30	-	3.60	-11.88
Window	-7	1.80	-	1.20	-15.12

Total Qty = 282.68 Sq.m

16 Providing and laying **cement concrete flooring 50mm thick** with M20 cement concrete laid to proper level and slope in alternate bays including compacting, filling joints, marking lines to give the

	1	10.20	16.24	-	165.65
--	---	-------	-------	---	--------

Total Qty = 165.65 Sq.m

17 Providing and fixing **mild steel grill work** for windows, ventilators etc. 20 Kilogram/Square Metre as per drawing including fixtures, necessary welding and painting with one coats of anticorrosive paint

Window	7	1.80	-	1.20	15.12
--------	---	------	---	------	-------

Total Qty = 15.12 Sq.m

18 Providing and fixing in position. (as per I.S.1868 / 1982) **Aluminium sliding window** of two tracks with rectangular pipe having overall dimension 763.50 x 38.10 x 1.02 mm at weight 0.547 kg/Rmt. and

Window	7	1.80	-	1.20	15.12
--------	---	------	---	------	-------

Total Qty = 15.12 Sq.m

19 **Solid Core Flush door Single leaf**

Providing and fixing factory made solid core flush door in single leaf 35 mm thick, decorative types, of

Door	0	0.90	-	2.10	0.00
------	---	------	---	------	------

Total Qty = 0.00 Sq.m

Er. K. D. Pardhi
BE (Civil), DCE

20 Providing and fixing **rolling shutter** fabricated from steel laths of minimum thickness 0.9 mm with lock plate of 3.15 mm thickness reinforced with 35 x 35 x 5 mm angle section fitted with sliding bolts and

RS	1	3.30	-	3.60	11.88
----	---	------	---	------	-------

Total Qty = **11.88** Sq.m

21 Providing and applying **priming coat** on concrete/ masonry/ Asbestos Cement plastered surfaces including scaffolding if necessary, preparing the surface by thoroughly cleaning oil, grease, dirt and

Internal	2	9.75	-	5.00	97.45
	2	16.24	-	5.00	162.40
Deduction for RS	-1	3.30	-	3.60	-11.88
Window	-7	1.80	-	1.20	-15.12

Total Qty = **232.85** Sq.m

22 Providing and applying **plastic emulsion paint** of approved quality, colour and shade to old and new surfaces in two coats including scaffolding, preparing the surface. (excluding the primer coat)etc.

Internal	2	9.75	-	5.00	97.50
	2	16.24	-	5.00	162.40
Deduction for RS	-1	3.30	-	3.60	-11.88
Window	-7	1.80	-	1.20	-15.12

Total Qty = **232.90** Sq.m

23 Providing and applying one coat of **seal cement primer** of approved manufacture and shed including scaffolding preparing the surface by cleaning dirt and other foreign matters, scrapping if necessary

External	2	10.20	-	5.60	114.24
	2	16.70	-	5.60	187.04
Chhaja	7	2.00	0.60	-	8.40
deduction for RS	-1	3.30	-	3.60	-11.88
Window	-7	1.80	-	1.20	-15.12

Total Qty = **282.68** Sq.m

24 Providing and applying two coats of **exterior acrylic emulsion paint** conforming to corresponding I.S. of approved manufacture and of approved colour to the plastered surfaces including cleaning

External	2	10.20	-	5.60	114.24
	2	16.70	-	5.60	187.04
Chhaja	7	2.00	0.60	-	8.40
deduction for RS	-1	3.30	-	4.60	-15.18
Window	-7	1.80	-	1.20	-15.12

Total Qty = **279.38** Sq.m

Er. K. D. Pardhi
BE (Civil), DCE

25 Providing and fixing colour coated Zincalume (R) AZ150 (min 150 gms/sq.mt. total on each side)
profiled sheets for roofing. The feed material is manufactured out of nominal 0.45 mm Base Metal

	1	11.40	16.70	-	190.38
Canopy	1	4.00	2.10	-	8.40
Total Qty =					198.78 Sq.m

26 Providing **structural steel work in hollow section** of various thickness and sizes in square, rectangular
and round shape from 25mm to 450mm section as per IS 4923 YST 310 Grade produced from iron ore
Steel @ 20 Kg/Sq.m 1 - - - 3.98

Total Qty = 3.98 M.T.

Er. K. D. Pardhi
BE (Civil), DCE

RATE ANALYSIS

Name of Work :-

PROPOSED CONSTRUCTION OF MACHINE SHED

SR NO	ITEM OF WORK	S.S.R. IT. NO	S.S.R. RATE	UNIT	TRANSPORTATION RATE			TOTAL TRANSPORTATION RATE	Deduct From S.S.R. Rate	TOTAL RATE
					MATERIAL	QTY	RATE AMT.			
1	Excavation for foundation in earth, soil of all types, sand, gravel and soft murum, including removing the excavated material	21.02	193.00	Cu.m	-	-	-	-	-	193.00
2	Excavation for foundation in earth, soils of all types, sand, gravel and soft murum, including removing the excavated material	21.03	306.00	Cu.m	-	-	-	-	-	306.00
3	Providing soling using 80mm size trap metal in 15cm. Layer including filling voids with Crushed sand/ grit, ramming,	21.40	1322.00	Cu.m	80mm metal	1.00	456.04	456.04	-	1778.00
4	Filling in plinth and floors with contractors material/brought from outside and approved by Engineer incharge in layers of	21.37	550.00	Cu.m	Murum	1.00	220.06	220.06	-	770.00
5	Providing and laying Cast in situ/Ready Mix cement concrete in M-10 of trap/ granite/quartzite/ gneiss metal for foundation and bedding including bailing out water. Steel centering,	24.01	5538.00	Cu.m	40mm Metal 20mm Metal Sand Cement	0.70 0.24 0.470 4.40	456.04 475.86 699.29 9.36	319.23 114.21 328.67 41.20	-120.00	6221.00
6	Providing and laying in situ /Ready Mix cement concrete M-20 of trap / granite /quartzite/ gneiss metal for R.C.C. work in foundations like raft, strip foundations, grillage and footings	25.11	6666.00	Cu.m	20mm Metal 12/10mm Metal Sand Cement	0.57 0.28 0.425 7.00	456.04 475.86 699.29 9.36	259.94 133.24 297.20 65.54	-120.00	7302.00
7	Providing and laying Cast in situ/Ready Mix cement concrete M-20 of trap / granite/quartzite/ gneiss metal for	25.31	12987.00	Cu.m	20mm Metal 12/10mm Metal Sand	0.57 0.28 0.425	456.04 475.86 699.29	259.94 133.24 297.20	-120.00	13623.00

E.P. K. D. Pardhi
BE (Civil), DCE

15	Providing sand faced plaster externally in cement mortar using approved screened sand, in all positions	32.11	599.00	Sq.m	Sand 0.033 Cement 0.25	699.29 9.36 25.42	23.08 2.34 0.00	624.00
16	Providing and laying cement concrete flooring 50mm thick with M20 cement concrete laid to proper level and slope in alternate bays including	33.13	547.00	Sq.m	Metal Sand Cement	475.86 699.29 9.36	20.94 15.38 3.42	587.00
17	Providing and fixing mild steel grill work for windows, ventilators etc. 20 Kilogram/Square Metre as per drawing	40.01	1845.00	Sq.m	-	-	-	1845.00
18	Providing and fixing in position, (as per I.S.1868 / 1982) Aluminium sliding window of two tracks with rectangular pipe	39.40	4769.00	Sq.m	-	-	-	4769.00
19	Solid Core Flush door Single leaf Providing and fixing factory made solid core flush door in single leaf 35 mm thick,	51.60	2750.00	Sq.m	-	-	-	2750.00
20	Providing and fixing rolling shutter fabricated from steel laths of minimum thickness 0.9 mm with lock plate of 3.15	39.25	4730.00	Sq.m	-	-	-	4730.00
21	Providing and applying priming coat on concrete/ masonry & Asbestos Cement plastered surfaces including scaffolding if	35.21	34.00	Sq.m	-	-	-	34.00
22	Providing and applying plastic emulsion paint of approved quality, colour and shade to old and new surfaces in two coats	36.12	70.00	Sq.m	-	-	-	70.00
23	Providing and applying one coat of seal cement primer of approved manufacture and shed including scaffolding preparing	35.22	19.00	Sq.m	-	-	-	19.00

Er. K. D. Pardhi
BE (Civil), DCE

24 Providing and applying two coats of exterior acrylic emulsion paint conforming to corresponding I.S. of approved

35.25 240.00 Sq.m

240.00

25 Providing and fixing colour coated Zincalume (R) AZ150 (min 150 gms/sq.mt. total on each side) profiled

38.34 1095.00 Sq.m

1095.00

26 Providing structural steel work in hollow section of various thickness and sizes in square, rectangular and round shape from

23.12 101994.00 Sq.m

101994.00

 Er. K. D. Pardhi
 BE (Civil), DCE

LEAD STATEMENT

Sl. No.	Description	Quantity	Unit	Rate	Total
1
2
3
4
5
6
7
8
9
10
11
12
13
14
15
16
17
18
19
20
21
22
23
24
25
26
27
28
29
30
31
32
33
34
35
36
37
38
39
40
41
42
43
44
45
46
47
48
49
50
51
52
53
54
55
56
57
58
59
60
61
62
63
64
65
66
67
68
69
70
71
72
73
74
75
76
77
78
79
80
81
82
83
84
85
86
87
88
89
90
91
92
93
94
95
96
97
98
99
100

PROPOSED CONSTRUCTION OF MACHINE SHED

LEAD STATEMENT

Sr.No.	Name of Material	Source of Supply	Lead in Kms	Transportation	Deduction of 5 Kms	Total Rs.	Say Rs.	Unit
1	2	3	4	5	6	7	8	9
1	Metal Above 40mm	Chirchadbandha	24.00	456.04	0.00	456.04	456.04	Cu.m
2	Metal Below 40mm	Chirchadbandha	24.00	475.86	0.00	475.86	475.86	Cu.m
3	Sand	Satona Ghat	42.00	699.29	0.00	699.29	699.29	Cu.m
4	Cement	Goregaon	8.00	187.27	0.00	9.36	9.36	Per bag
5	Steel	Goregaon	8.00	187.27	0.00	187.27	187.27	M.T.
6	Bricks	Goregaon	8.00	603.12	0.00	0.60	0.60	Nos.
7	Murum	Local	5.00	220.06	0.00	220.06	220.06	Cu.m

Er. K. D. Pardhu
BE (Civil), DCE

MATERIAL TESTING STATEMENT

I. NO.	Item of work	Total Qty.	Unit	Test Details		Testing Amount	Total Amount
				Frequency	No. of test		
1	Cement Concrete cube Compressive Strength (M-10)	24.39	Cu.m	minimum 6 cubes & 6 beams per day's work whichever is more.	4	690	2760.00
2	Cement Concrete cube Compressive Strength (M-20)	21.71	Cu.m		4	690	2760.00
						Total Rs.	5520.00

 Er. K. D. Pardihi
 BE (Civil), DCE

ROYALTY STATEMENT

PROPOSED CONSTRUCTION OF MACHINE SHED

Sr. No.	Name of Material	Qty.	Unit	Rate of Material Consumption per Unit			Material Consumption		
				Metal	Sand	Murum	Metal	Sand	Murum
3	Providing soling using 80mm size trap metal in 15cm. Layer including	34.48	Cu.m	1.00	0.15	0.00	34.48	5.17	-
4	Filling in plinth and floors with contractors material/brought from	59.49	Cu.m	0.00	0.00	1.00	-	-	59.49
5	Providing and laying Cast in situ/Ready Mix cement concrete in M-10 of trap/ granite/quartzite/	24.39	Cu.m	0.70	0.47	0.00	17.08	11.47	-
6	Providing and laying in situ /Ready Mix cement concrete M-20 of trap /	6.91	Cu.m	0.00	0.425	0.00	-	2.94	-
7	Providing and laying Cast in situ/Ready Mix cement concrete M-	11.42	Cu.m	0.00	0.425	0.00	-	4.85	-
8	Providing and laying Cast in situ/Ready Mix cement concrete M-	9.45	Cu.m	0.00	0.425	0.00	-	4.02	-
9	Providing and laying Cast in situ/Ready Mix cement concrete M-	0.00	Cu.m	0.00	0.425	0.00	-	0.00	-
10	Providing and laying Cast in situ/Ready Mix cement concrete M-	0.84	Cu.m	0.00	0.425	0.00	-	0.36	-
12	Providing fly ash brick masonry with conventional / I.S. type fly ash bricks in C.M. 1:6 in foundation and	4.48	Cu.m	0.00	0.320	0.00	-	1.43	-
13	Providing fly ash brick masonry with conventional/ I.S. type bricks in cement mortar 1:6 in superstructure	54.63	Cu.m	0.00	0.320	0.00	-	17.48	-
14	Providing internal cement plaster 20mm thick in Single coats in	232.85	Sq.m	0.00	0.025	0.00	-	5.82	-
15	Providing sand faced plaster externally in cement mortar using	282.68	Sq.m	0.00	0.033	0.00	-	9.33	-
16	Providing and laying cement concrete flooring 50mm thick with	165.65	Sq.m	0.00	0.022	0.00	-	3.64	-
Total Quantity							51.56	66.51	59.49
Rate Rs.							216.18	237.37	216.18
Amount Rs.							11146.33	15787.51	12859.59
Total Amount Rs.							39793.00		

a) For sand = Royalty + surcharge (2%) + Distt. Mineral Foundation Cess (10%)

= 211.95+4.23+21.19 = 237.37 Per Cum

b) For All Other Minerals = Royalty + surcharge (2%)

= 211.95+4.23 = 216.18 per cum

 Er. K. D. Pardhi
 BE (Civil), DCE

NAME OF WORK :- PROPOSED CONSTRUCTION OF MACHINE SHED

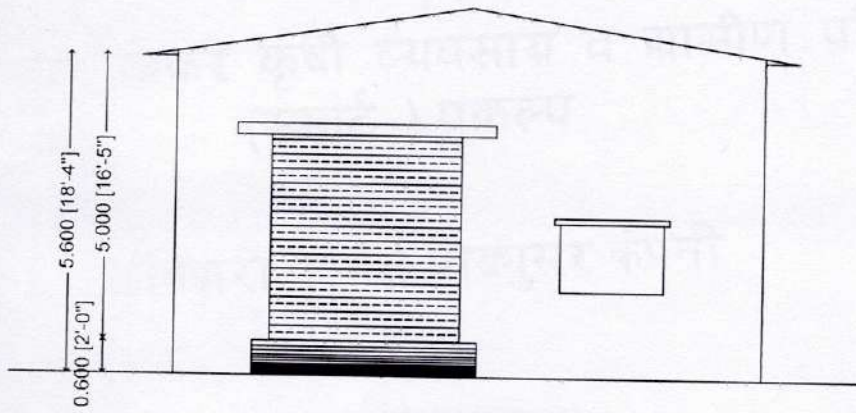

ELEVATION

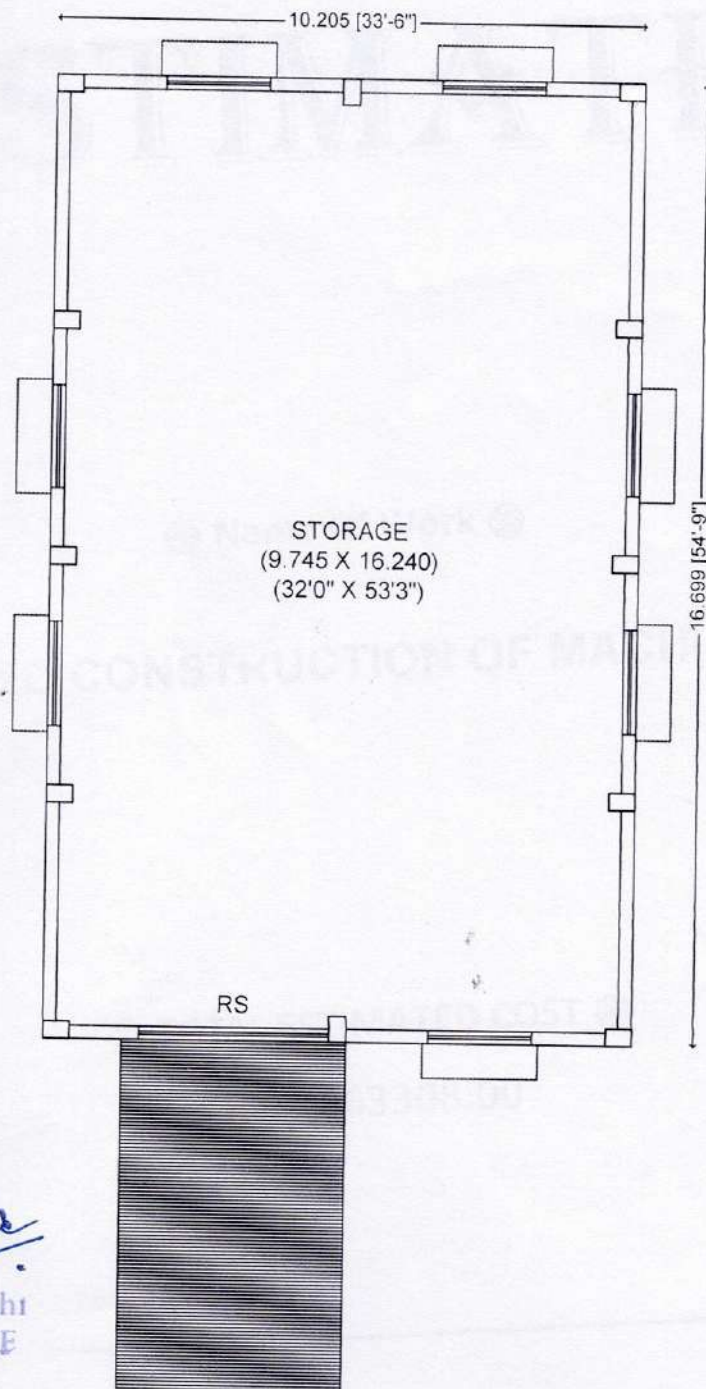

PLAN

Er. K. D. Pardhi
BE (Civil), DCE